

SITE PLAN - TERMINAL AND ASSOCIATED FACILITIES
SCALE 1:1,000 @ A1

LEGEND

- PROPOSED CODE 3 RUNWAY
- PROPOSED CODE C TAXIWAY AND APRON
- PROPOSED TERMINAL
- PROPOSED CARPARK
- FUTURE CARPARK
- PROPOSED LANDSCAPING AND TREES
- EXISTING BITUMEN EDGE

SUMMARY

	LENGTH	WIDTH
RUNWAY (CODE C)	1700m	30m
RUNWAY STRIP (CODE C)	1820m	150m
TAXIWAY (CODE C)	-	18m
TAXIWAY STRIP (CODE C)	-	28m

NOTE:
LAYOUT IS INDICATIVE ONLY.
NO DEDICATED SITE SURVEY PROVIDED.
LAYOUT BASED ON AERIAL VIEW ONLY.

PRELIMINARY
NOT FOR CONSTRUCTION
DATE 20.07.20 09:37 AM

REFERENCE COORDINATION DRAWINGS		SURVEY DATUM	
DESCRIPTION	DRAWING NO.	HORIZONTAL DATUM	VERTICAL DATUM

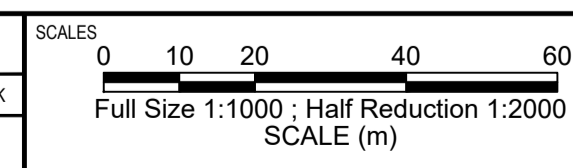

A1 ORIGINAL
DO NOT SCALE THIS DRAWING

APPROVED

SIGNED: _____

DATE: _____ RREQ: _____

© Phronis Pty Ltd.

PHRONIS CONSULTING

Lvl 5 Bldg 2 50 McDougall St, Milton, Qld 4064
T (07) 3506 1100 Fax (07) 3229 8177
Website: www.phronis.com.au

Waratah Coal
THE NEW ENERGY IN COAL

PROJECT: WARATAH COAL ALPHA AIRPORT

TITLE: SITE PLAN - TERMINAL AND ASSOCIATED FACILITIES

DRAWING STATUS: PRELIMINARY NOT FOR CONSTRUCTION			
DESIGNED: MB	CHECKED: PJS	APPROVED: PJS	DATE: 20.07.20
PROJECT No: S1920300	DRAWN: MB	DATE: 20.07.20	REV: B
DRAWING No: - CIV -		- SK02	

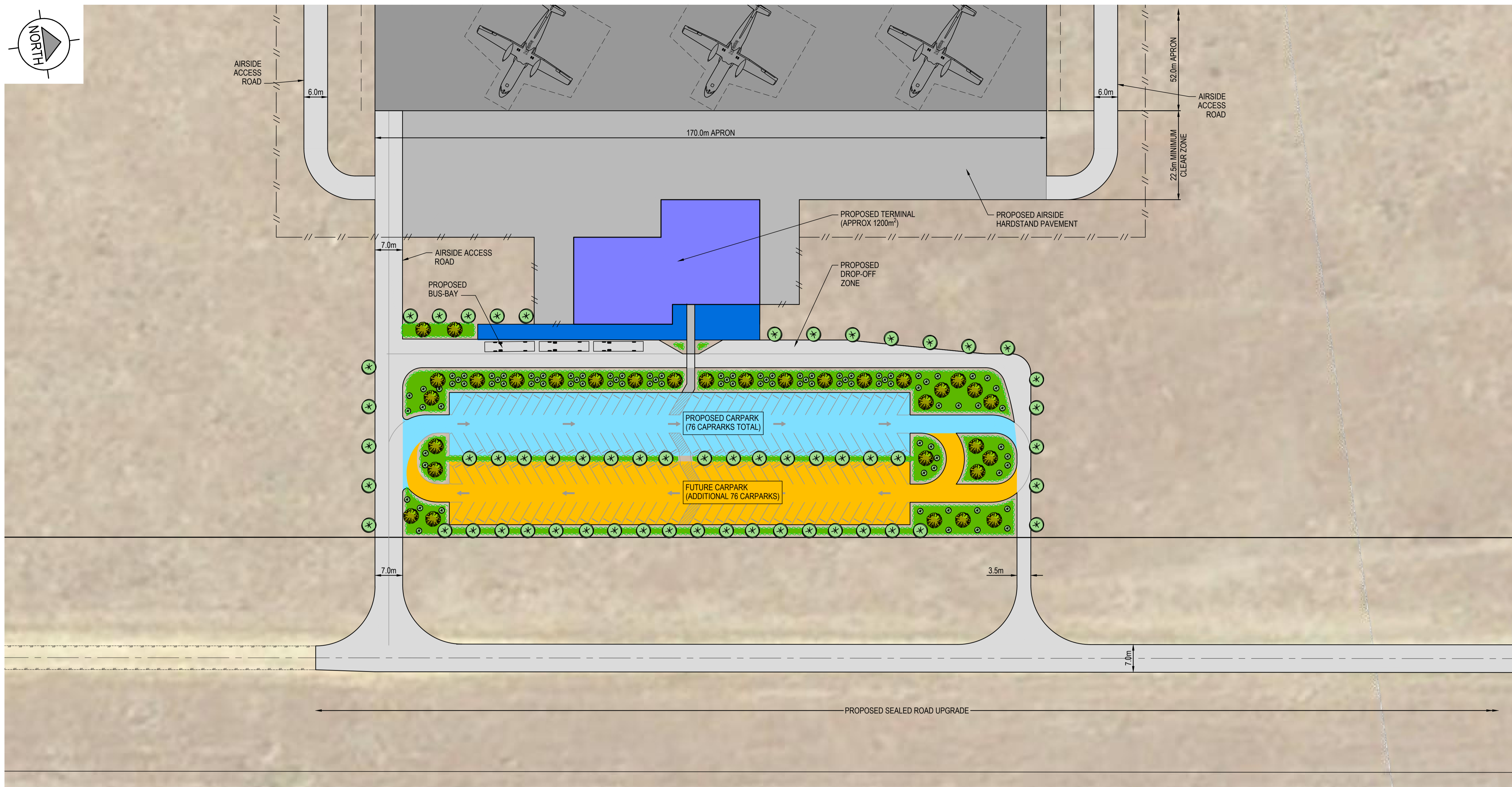

SITE PLAN - TERMINAL AND CARPARK
SCALE 1:500 @ A1

LEGEND

- PROPOSED CODE 3 RUNWAY
- PROPOSED CODE C TAXIWAY AND APRON
- PROPOSED TERMINAL
- PROPOSED CARPARK
- FUTURE CARPARK
- PROPOSED LANDSCAPING AND TREES
- EXISTING BITUMEN EDGE

SUMMARY

	LENGTH	WIDTH
RUNWAY (CODE C)	1700m	30m
RUNWAY STRIP (CODE C)	1820m	150m
TAXIWAY (CODE C)	-	18m
TAXIWAY STRIP (CODE C)	-	28m

NOTE:
LAYOUT IS INDICATIVE ONLY.
NO DEDICATED SITE SURVEY PROVIDED.
LAYOUT BASED ON AERIAL VIEW ONLY.

PRELIMINARY
NOT FOR CONSTRUCTION
DATE 20.07.20 09:37 AM

B A 20.07.20 15.07.20 MB MB FOR INFORMATION FOR INFORMATION	MB MB FOR INFORMATION FOR INFORMATION	PJS PJS PJS PJS	PJS PJS CHK APPD	REFERENCE COORDINATION DRAWINGS				SCALES 0 5 10 20 30 Full Size 1:500 ; Half Reduction 1:1000 SCALE (m)	A1 ORIGINAL DO NOT SCALE THIS DRAWING APPROVED SIGNED: _____ DATE: _____ RREQ: _____ © Phronis Pty Ltd.	CLIENT: PHRONIS CONSULTING Lvl 5 Bldg 2 50 McDougall St, Milton, Qld 4064 T (07) 3506 1100 Fax (07) 3229 8177 Website: www.phronis.com.au	PROJECT: WARATAH COAL ALPHA AIRPORT TITLE: SITE PLAN - TERMINAL AND CARPARK	DRAWING STATUS: PRELIMINARY NOT FOR CONSTRUCTION DESIGNED: MB CHECKED: PJS APPROVED: PJS PROJECT No: S1920300 DRAWN: MB DATE: 20.07.20 DRAWING No: -CIV- -SK03 REV: B
				SURVEY DATUM HORIZONTAL DATUM: _____ VERTICAL DATUM: _____								

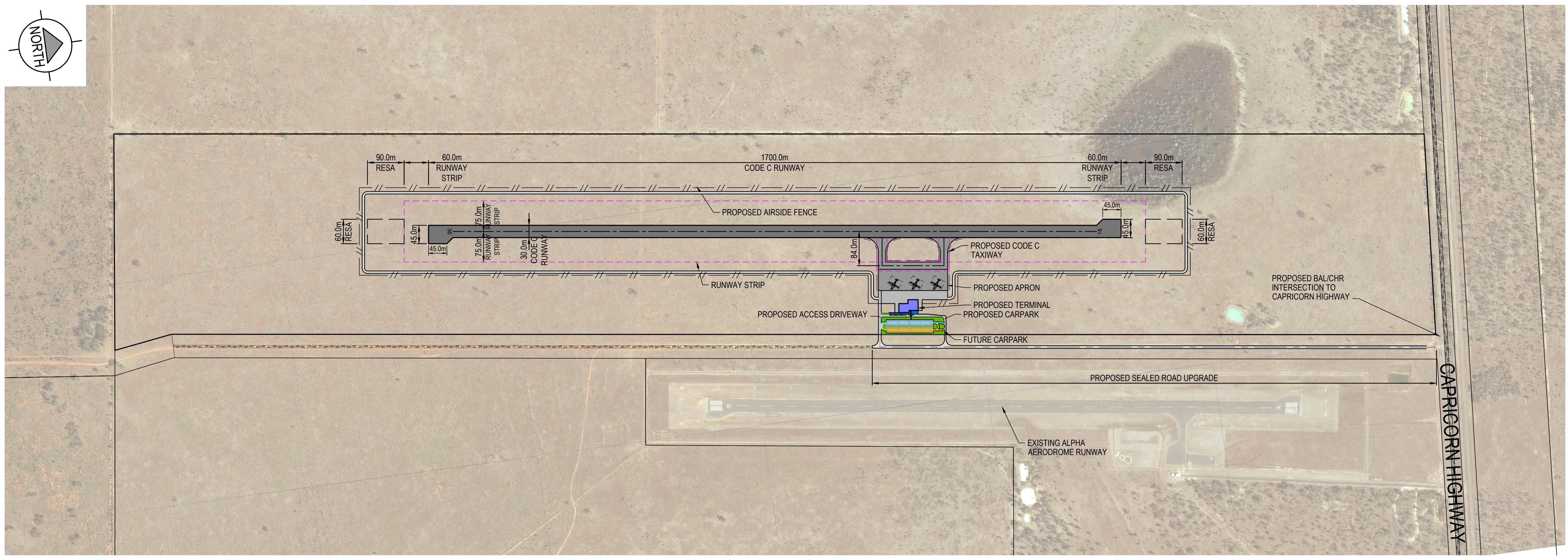

SITE PLAN - AIRPORT
SCALE 1:5,000 @ A1

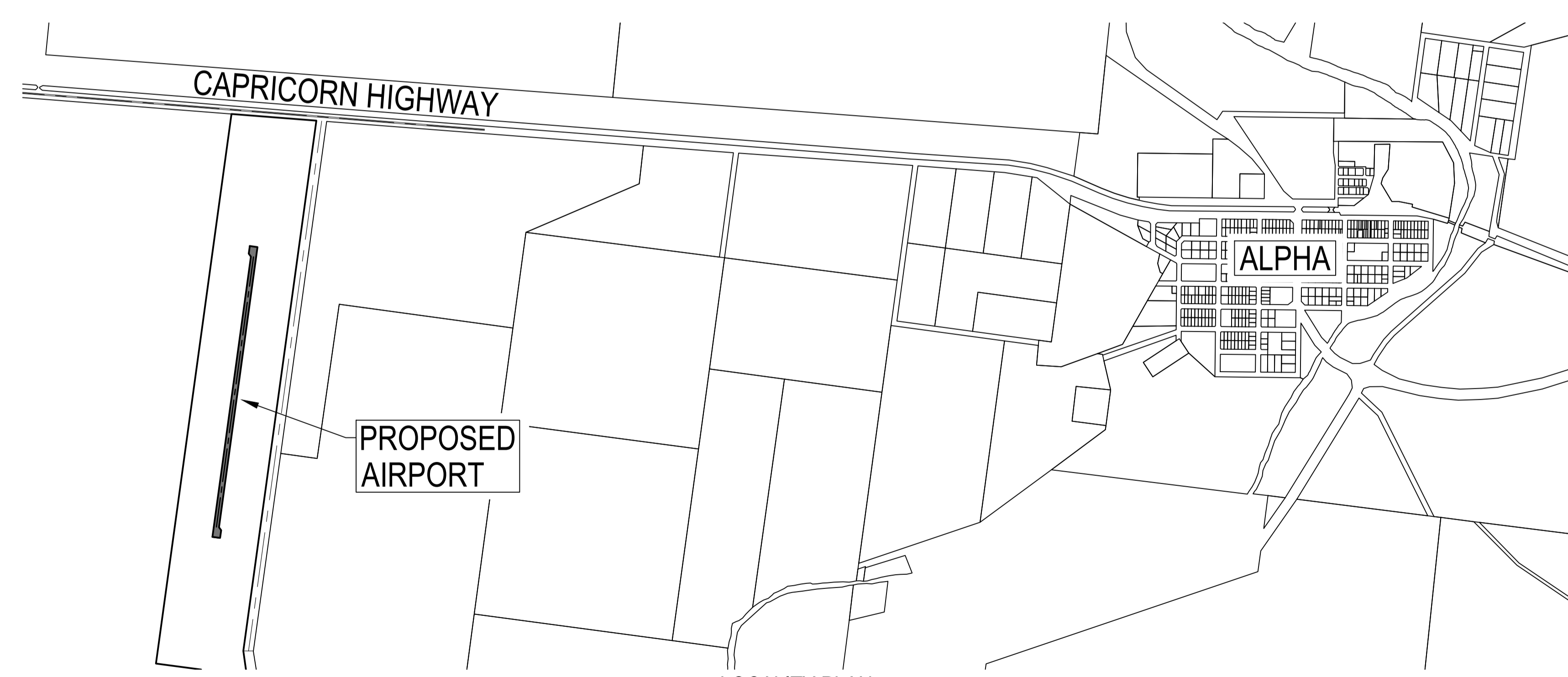

LOCALITY PLAN
SCALE 1:20,000 @ A1

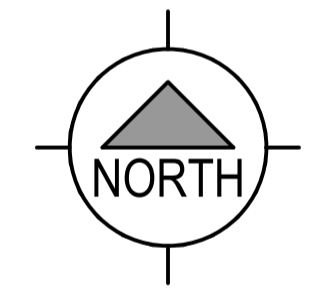

LEGEND

- PROPOSED CODE 3 RUNWAY
- PROPOSED CODE C TAXIWAY AND APRON
- PROPOSED TERMINAL
- PROPOSED CARPARK
- FUTURE CARPARK
- PROPOSED LANDSCAPING AND TREES
- EXISTING BITUMEN EDGE

SUMMARY

	LENGTH	WIDTH
RUNWAY (CODE C)	1700m	30m
RUNWAY STRIP (CODE C)	1820m	150m
TAXIWAY (CODE C)	-	18m
TAXIWAY STRIP (CODE C)	-	28m

NOTE:
LAYOUT IS INDICATIVE ONLY.
NO DEDICATED SITE SURVEY PROVIDED.
LAYOUT BASED ON AERIAL VIEW ONLY.

PRELIMINARY
NOT FOR CONSTRUCTION
DATE 20.07.20 09:37 AM

File name: S:\S1920300\WARRATAH COAL ALPHA AIRPORT\DRAWINGS\S1920300 - AIRPORT LAYOUT.DWG, printed on Monday, 20 July 2020 9:37:36 AM, by Matthew Bray

B A REV	20.07.20	MB	FOR INFORMATION	PJS	PJS	SCALES 0 50 100 200 300 Full Size 1:5000 ; Half Reduction 1:10000 SCALE (m) 0 200 400 800 1200 Full Size 1:20000 ; Half Reduction 1:40000 SCALE (m)	A1 ORIGINAL DO NOT SCALE THIS DRAWING	Phronis Consulting Lvl 5 Bldg 2 50 McDougall St, Milton, Qld 4064 T (07) 3506 1100 Fax (07) 3229 8177 Website: www.phronis.com.au	Waratah Coal THE NEW ENERGY IN COAL	PROJECT: WARRATAH COAL ALPHA AIRPORT	DRAWING STATUS: PRELIMINARY NOT FOR CONSTRUCTION
	15.07.20	MB	FOR INFORMATION	PJS	PJS		APPROVED			SIGNED: _____ DATE: _____ RREQ: _____	CLIENT:
										TITLE: SITE PLAN - AIRPORT	APPROVED: PJS DATE: 20.07.20
										DRAWING No:	REV:
										- CIV -	- SK01
											B